

Installation Guide for Overflow Sensor with Ground, KlikMate Kit #2– #4687320

Parts List:

1885408	Mach. screw, #6-32 x .50, SS
1907013	Hex nut, 6-32, SS
4674501	Wire assy, valves, blower, latch, cap-sense
4685403	PCB, overflow sensor
4687200	Holder, overflow sensor
4687420	Instructions, overflow sensor w/ ground only

Introduction

These instructions will retrofit the glassware washer's Overflow Sensor with the Overflow Sensor with Ground wire. This fix addresses issues with Fill Failures.

The included wire assembly, 4674501, does not need to be installed unless the connector to the sensor is damaged!

Uninstall the Overflow Sensor:

1. Disconnect power to the glassware washer.
2. Mark the location of the Overflow Sensor so the new sensor can go back at the same location.
3. Remove the Overflow Sensor assembly by removing the screw and nut on the sensor holder.
4. Disconnect the connector by pushing in on the detent on the connector and pull on the connector (***Do not pull on the wires!***).

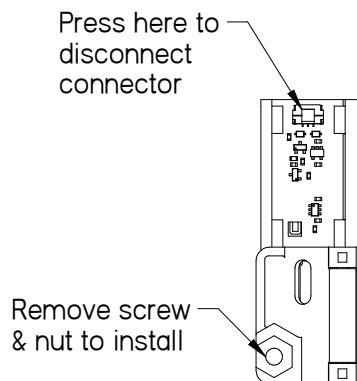

Install the Overfill Sensor:

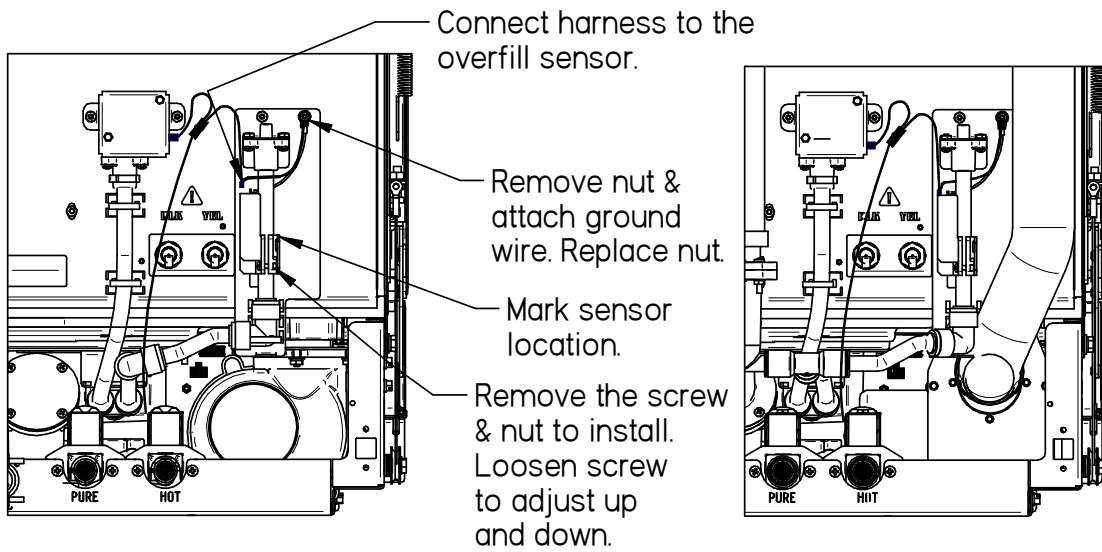

SteamScrubber

FlaskScrubber

1. Connect the wire assembly connector to the new Overfill Sensor. If the connector is damaged, use the supplied wire assembly.
2. Install the new Overfill Sensor in the same location with the screw and nut. Pass the green ground wire behind the tube.
3. Remove the nut that holds the Overfill Sensor mounting bracket and connect the green ground wire. Replace the nut.
4. Continue to next page for setting sensor height.

Set Overfill Sensor:

1. Turn the power back on
2. Go to the Maintenance Screen, and touch for 2 to 5 seconds the top and bottom left corners of the display simultaneously to get to the Factory Settings page.
3. Perform a factory fill. Once completed change the fill time to 5 and continue to fill the tank. Continue filling the tank. You will receive the High Water Alarm. Keep filling until the water level touches the baffle retainer on the front of the washer. Turn off the water immediately by pressing the “OK” and “STOP FILL” buttons on the display.
4. Check the water level in the tank. The water level should be just touching the baffle retainer. The blue light on the overfill sensor should be on.
 - a. If the water level didn't reach the baffle retainer, the sensor should be moved up. Add water until it reaches the baffle retainer and the blue light turns on.
 - b. If the blue light is not on, the sensor should be moved down.
5. Raise the sensor up 1/8” above this until the light goes off. Tighten the screw (do not overtighten).
6. Drain the water and repeat step 4 to confirm that the Overfill Sensor is set correctly. **Caution:** *In the Factory Fill Screen only, you can continue to add water over the High Water Alarm until the Overfill Sensor actuates. If the Overfill Sensor is set too low, you will never get the High Water Alarm. If the Overfill Sensor is set too high and never actuates you can continue to add water and over run the tank.*

Approximate fill level (at baffle retainer)

View of inside washer, front left corner.

