



PARTS LIST
GLASSWARE WASHER
STEAM MODELS

CONVERTIBLE PORTABLE

LCP 44000

UNDERCOUNTER

LSS 44003

FREE STANDING

LCF 44004

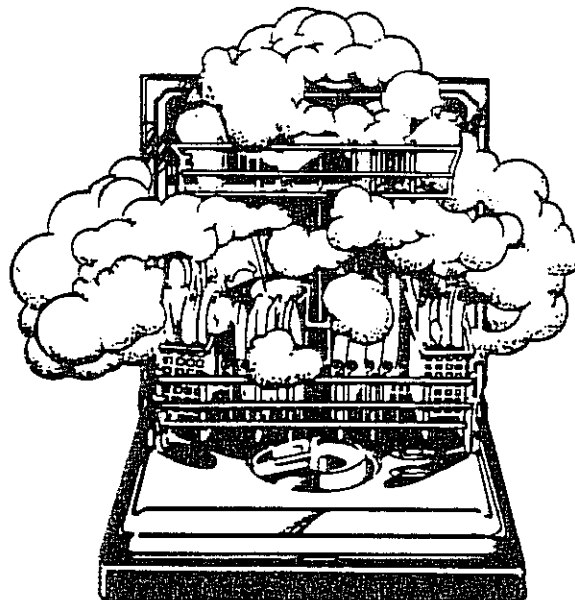

Lit.No.90-22-039
REVISION A
February, 1989

1988 - 1991 ish

CONTENTS

	Page
Introduction	A
ILLUSTRATIONS	
Tank and Related Parts1
Door with Detergent Cup & Thermostats2
Control Panel, Float Switch, Support Channel Parts3
Reversible Pump Exploded Drawing4
Blower & Duct Assy. and Baskets5
Portable Convertible Models Parts6
Distilled Water Pump7
 PARTS LIST8-10

Introduction to Parts Catalog

MODEL NUMBER

There are three models in this line of Labconco Glasswashers, all of which provide for the injection of distilled water for rinsing. The models may use an optional distilled water pump.

The models are:

- 44000 - Portable Model
- 44003 - Undercounter Model
- 44004 - Freestanding Model

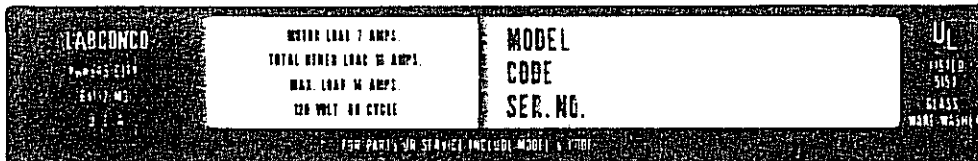

CODE LETTERS
Indicate month and
year of production

NOTE: A nameplate like the one shown above is located under the door handle.

HOW TO USE THIS PARTS LIST

1. To assure receipt of the correct parts, it is first necessary to determine the complete model number, sequence code, and date code from the nameplate.
2. Locate the part on an illustration and see the item number.
3. Use this number to find the part number in the list in back of this book.
4. For parts not illustrated, the parts are also listed in alphabetical order in the "Description" column as shown below.

ITEM NUMBER

Gives part identification on illustrations. Numbers listed in numerical order

REMARKS

This column further describes parts, showing hardware, part usage or locations.

ITEM NO.	PART NUMBER	DESCRIPTION	MODELS	REMARKS
			LCP 44000 LSS 44003 LCF 44004	

DESCRIPTION

Part are listed by name in alphabetical order

MODELS

Quantity of parts used on applying models

ITEMS NOT ILLUSTRATED
ON THIS LIST

- 8 - Blanket, Top -All Models
- 19 - Bracket -Timer Mount
- 38 - Connector -Blower Harness
- 46 - Junction Box Cover
- 49 - Shower Curtain
- 63 - Harness -Main
- 79 - Insulation -Door Panel
- 80 - Insulation -Lower panel
- 100- Panel -Rear, White
- 121- Rivets -Retainer to Tank
- 127- Screw -Strike Place
- 162- Tube, Drain -Copper
- 172- Washer -Tie Rod

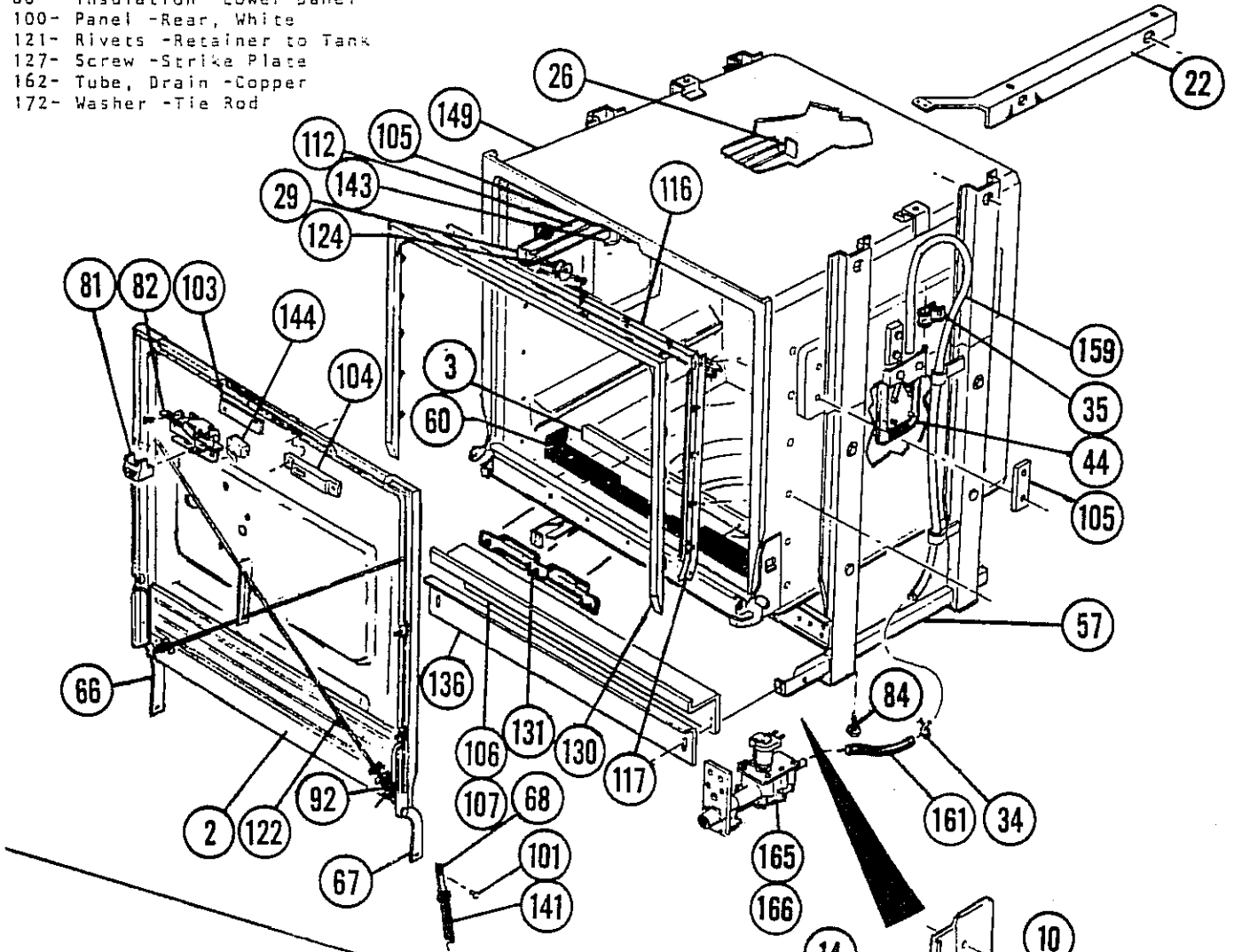

01-36-902 CORNER SEAL (2)
SCREW-09-00-859 (4)

01-36-911 GASKET CORNER (2)

01-36-898 DOOR SEAL

DOOR SEAL
STARTING
SERIAL NO.
870800788

01-36-900 TOP RETAINER

RETAINER RIVETS=
09-00-562 (19)

01-36-901 LEFT & RIGHT
SIDE RETAINER (2)

09-01-563
VINYL SEAL TAPE

HOLDDOWN BRACKET
(STARTS SERIAL NO.
8606000314)

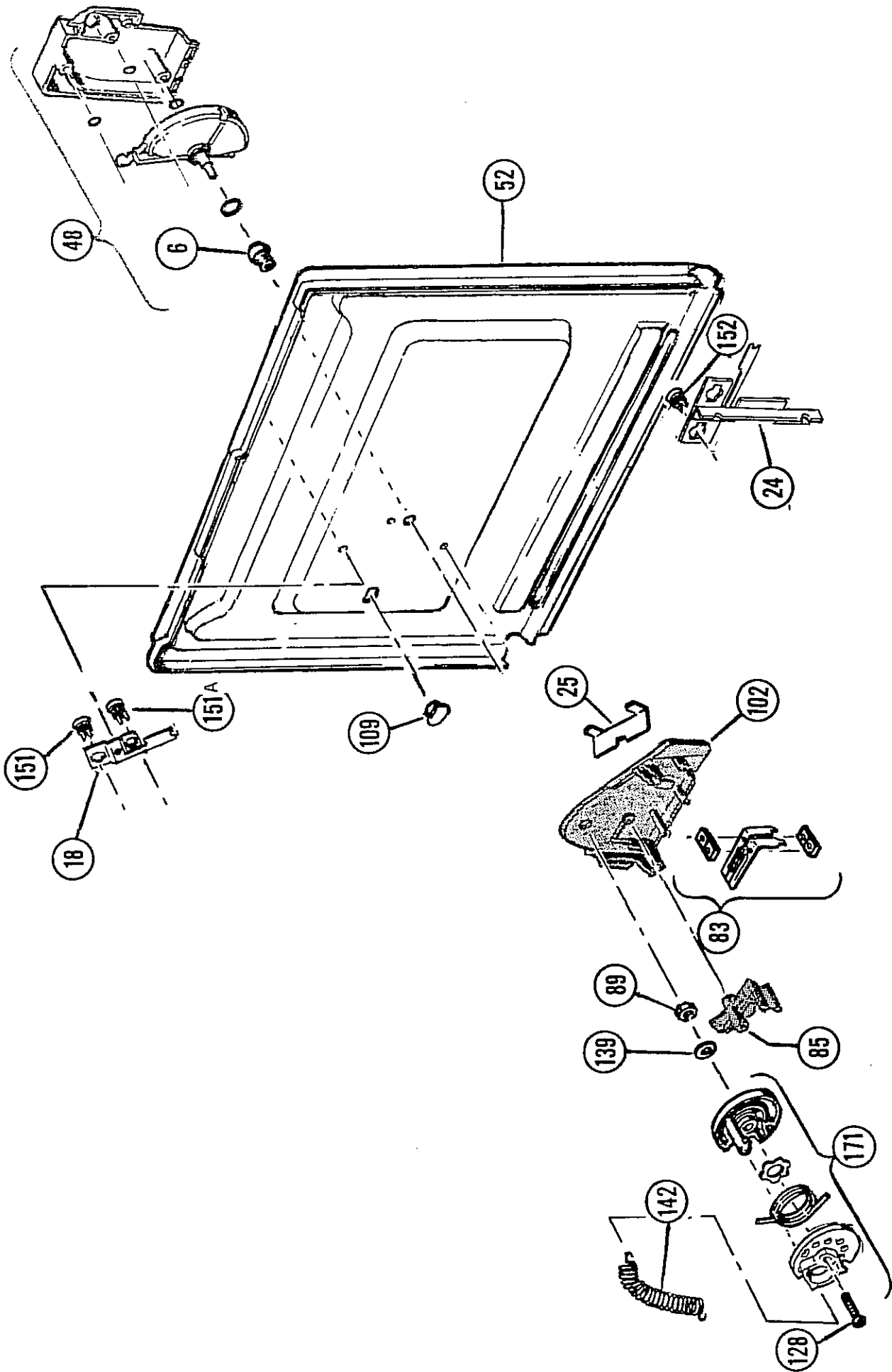

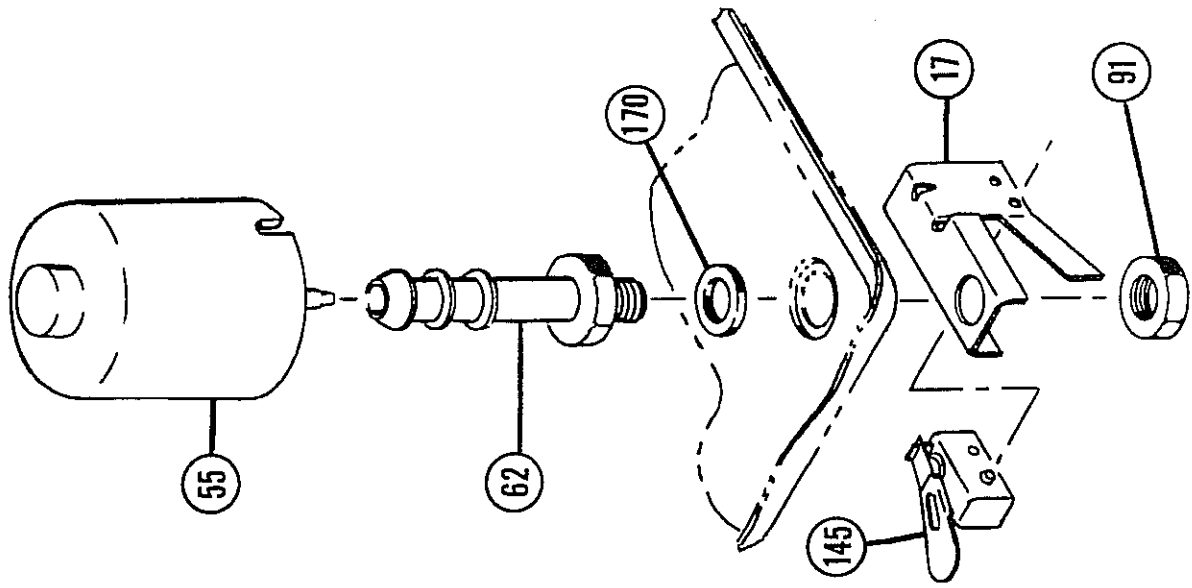
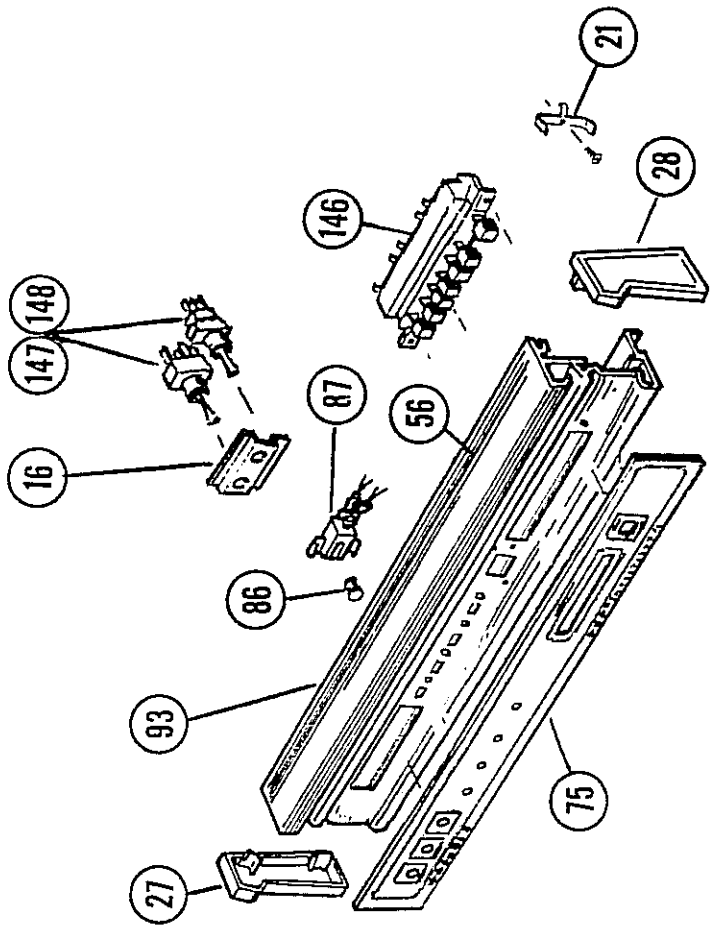

FLOAT SWITCH

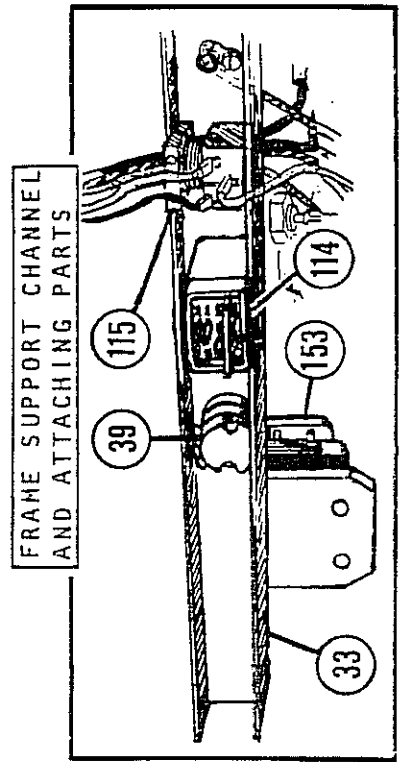

FRAME SUPPORT CHANNEL AND ATTACHING PARTS

REVERSIBLE PUMP

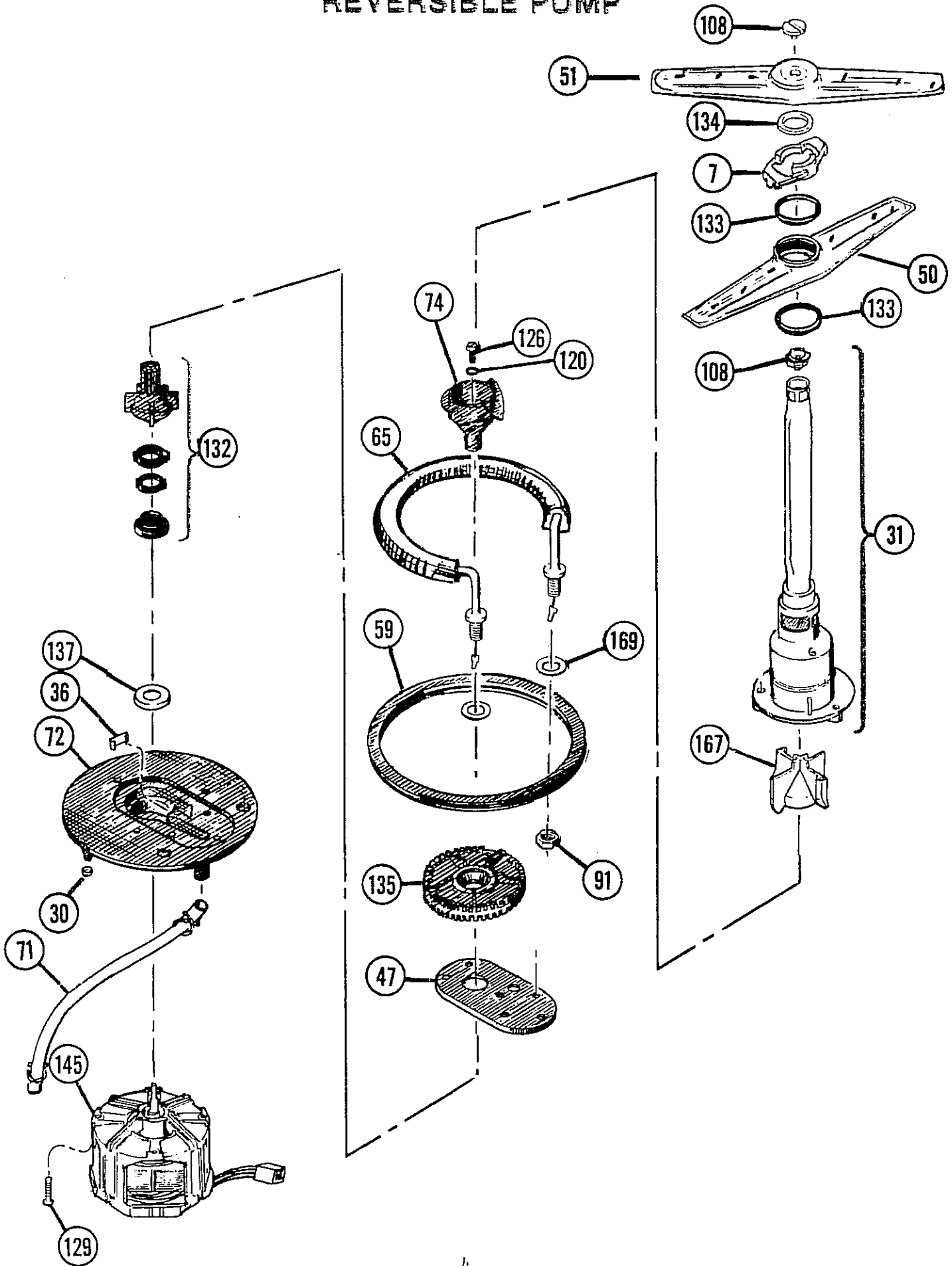

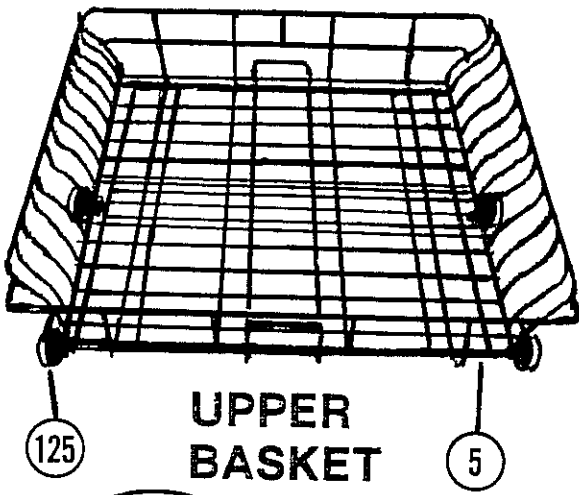

UPPER BASKET

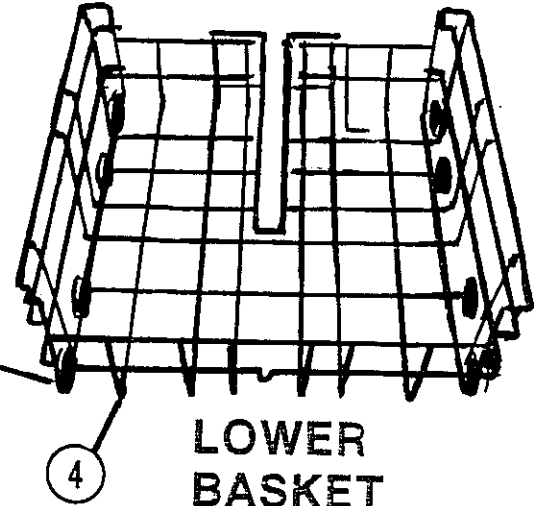

LOWER BASKET

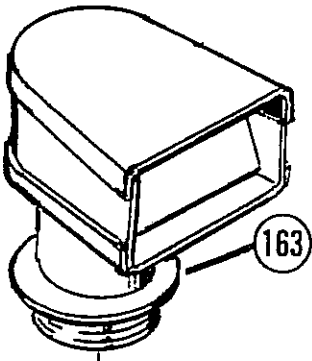

163

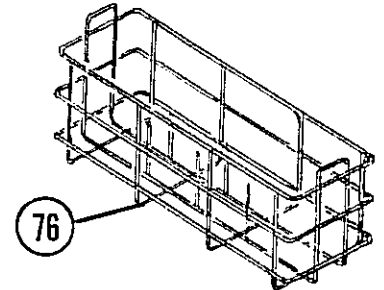

LOWER BASKET INSERT

BLOWER & DUCT ASSEMBLY

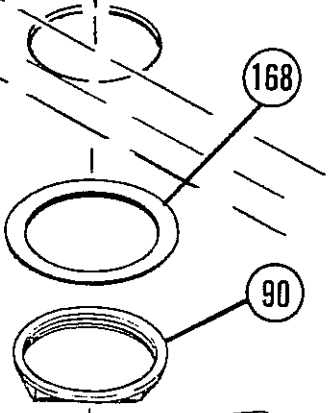

168

90

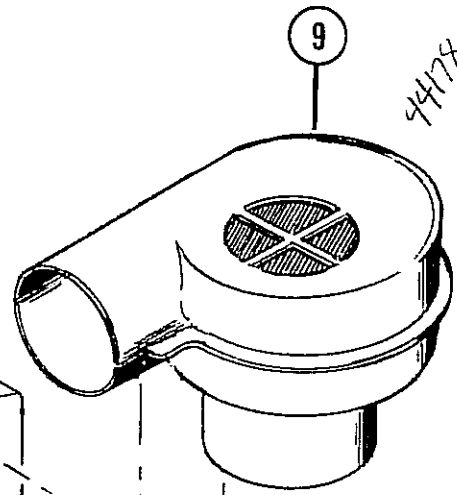

9

447800

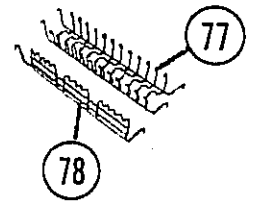

UPPER BASKET INSERTS

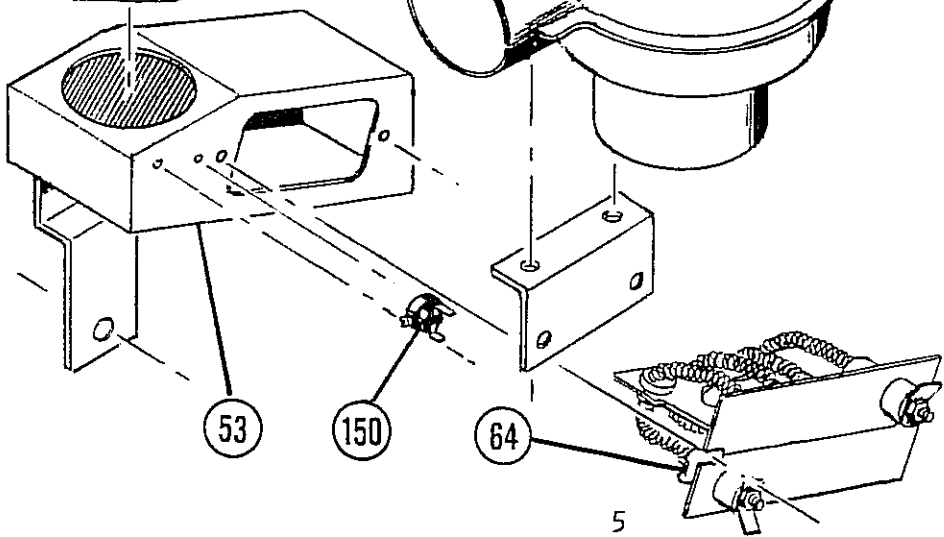

53

150

64

5

PORTABLE-CONVERTIBLE MODELS

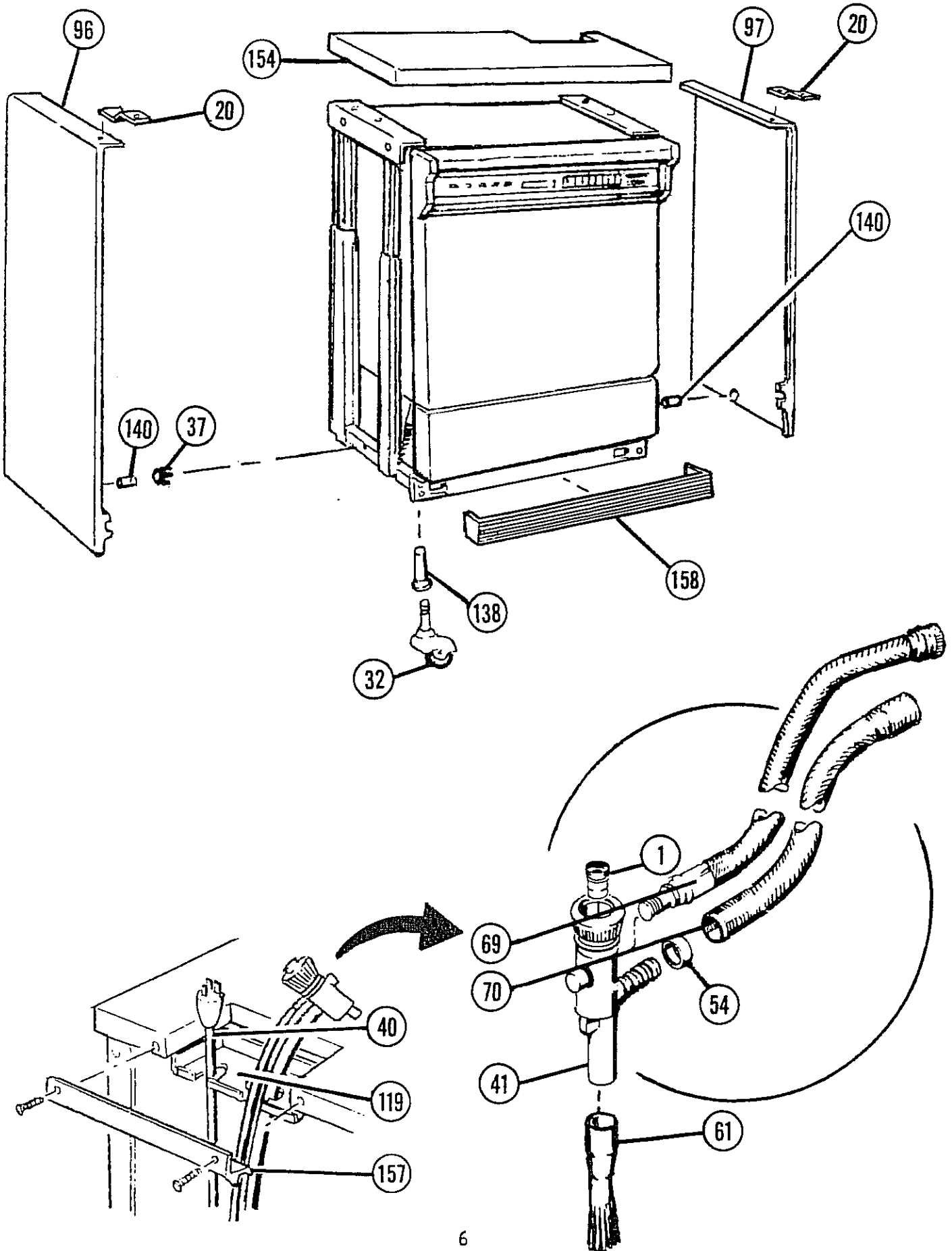

GARDEN
HOSE
WASHER

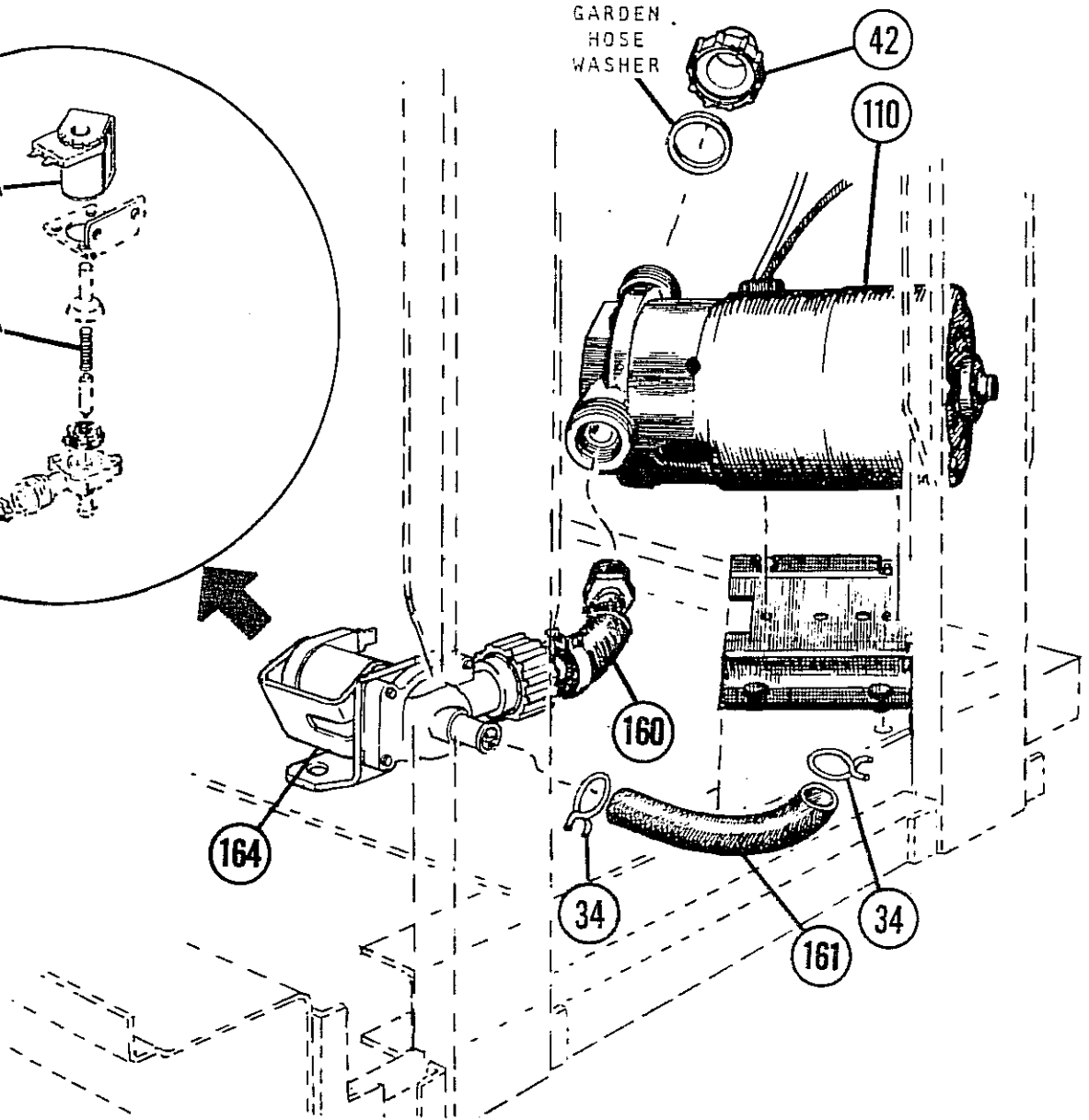
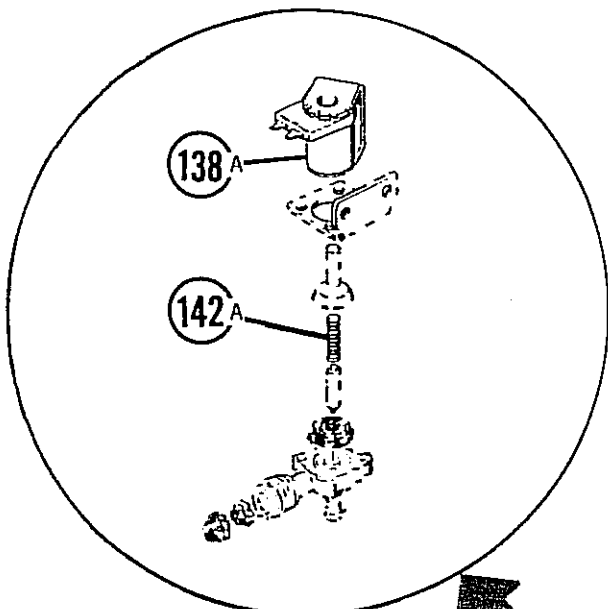

ITEM NO.	PART NO.	DESCRIPTION	MODELS			REMARKS
			LCP 44000	LSS 44003	LCF 44004	
1	00-44-017	AERATOR	1			
2	01-35-077	BAFFLE ASSEMBLY-INNER DOOR	1	1	1	
3	01-32-250	BAFFLE-TANK KIT	1	1	1	
4	01-34-736	BASKET-LOWER	1	1	1	
5	01-34-628	BASKET-UPPER	1	1	1	LESS INSERTS
6	01-35-734	BEARING-DET. CUP	1	1	1	
7	01-31-295	BEARING-LOWER DIST. ARM	1	1	1	
8	01-36-713	BLANKET-TANK (NOT ILLUSTRATED)	1	1	1	01-34-071 STRAPS 4
9	01-33-546	BLOWER ASSEMBLY	1	1	1	00-57-141 SCREWS 2
10	01-34-389	BRACKET-HINGE KIT, RIGHT	1	1	1	ENTIRE BRACKET BROKEN
	01-34-390	BRACKET-HINGE KIT, LEFT	1	1	1	" " "
12	01-32-228	BRACKET-HINGE, KIT, LEFT	1	1	1	SUPPORT HOOK BROKEN
	01-32-229	BRACKET-HINGE, KIT RIGHT	1	1	1	" " "
14	01-32-225	BRACKET-HINGE KIT, LEFT	1	1	1	STOP TAB BROKEN OFF
	01-32-224	BRACKET-HINGE KIT, RIGHT	1	1	1	" " " "
16	01-36-053	BRACKET-TOGGLE SWITCH	1	1	1	09-01-380 SCREWS 2 09-00-852 WASHERS 2
17	01-33-966	BRACKET-FLOAT SWITCH	1	1	1	09-01-254 SCREW 1 09-01-403 NUT 1
18	01-35-749	BRACKET-THERMOSTAT	1	1	1	09-01-466 SCREW 1
19	01-34-992	BRACKET-TIMER MOUNT	1	1	1	09-00-880 SCREWS 2
20	01-32-583	BRACKET-FRONT TOP TO PANEL	2		2	09-01-331 SCREWS 2
21	01-32-806	BRACKET-PUSH BUTTON SWITCH	2	2	2	
22	01-32-330	BRACKET-HOLD DOWN, RIGHT	1	1	1	09-00-789 SCREWS 4
	01-32-326	BRACKET- HOLD DOWN, LEFT	1	1	1	" " "
24	01-35-729	BRIDGE-THERMOSTAT BRACKET LONG	1	1	1	
25	01-35-828	BRIDGE-THERMOSTAT BRACKET SHORT	1	1	1	
26	01-31-713	BUMPER-UPPER BASKET RAIL	2	2	2	AT REAR OF RAIL
27	01-31-427	CAP END-ESCUTCHEON LEFT	1	1	1	09-00-752 SCREWS 2
28	01-31-428	CAP END-ESCUTCHEON RIGHT	1	1	1	" " "
29	01-30-892	CAP END-UPPER BASKET RAIL	2	2	2	AT FRONT OF RAIL
30	09-01-032	CAPSERT-MOTOR MOUNT	4	4	4	
31	01-33-811	CASE DIFFUSION ASSEMBLY	1	1	1	09-01-036 SCREWS 3
32	09-00-897	CASTERS	4			01-32-505 BRACKETS 2
33	01-35-346	CHANNEL-FRAME SUPPORT	1	1	1	
34	09-00-415	CLAMP-TUBE, FILL VALVE	2	2	2	DISTILLED AND DOMESTIC
35	01-36-903	CLAMP-FILL TUBE TO TANK	1	1	1	00-44-363 NUT 09-00-851 SCREW 09-00-852 WASHER
36	01-33-212	CLIP-MOTOR PROTECTOR	1	1	1	
37	09-00-938	CLIP-PANEL TO CASTER FRAME	2		2	
38	01-36-099	CONNECTOR-BLOWER HARNESS	1	1	1	
39	01-35-173	CONTROL EXPANDER CYCLE	1	1	1	09-01-382 SCREWS 2
40	01-36-301	CORD-POWER	1			
41	00-09-722	COUPLING ASSEMBLY-FAUCET	1			
42	09-00-984	COUPLING & SLEEVE	2	2	2	DISTILLED WATER PUMP
44	01-32-392	COVER ASSEMBLY-FILL TRAP	1	1	1	09-00-850 SCREWS 6
46	01-31-722	COVER-JUNCTION BOX	1	1	1	NOT ILLUSTRATED
47	01-34-156	COVER-DRAIN PUMP	1	1	1	09-01-035 SCREWS 6
48	01-35-974	CUP-DETERGENT	1	1	1	
49	01-32-813	CURTAIN SHOWER-P. B. SWITCH	1	1	1	NOT ILLUSTRATED
50	01-36-872	DISTRIBUTOR ARM-LOWER	1	1	1	
51	01-36-724	DISTRIBUTOR ARM-UPPER	1	1	1	
52	01-35-656	DOOR-INNER LINER	1	1	1	
53	01-34-447	DUCT & BRACKET ASSEMBLY	1	1	1	00-57-141 SCREWS 2
54	09-00-941	FERRULE-DRAIN HOSE	1			
55	01-33-967	FLOAT-FLOAT SWITCH	1	1	1	
56	01-36-046	FRAME-ESCUTCHEON	1	1	1	
57	01-35-489	FRAME-TANK SUPPORT LEFT SIDE	1	1	1	
	01-35-490	FRAME-TANK SUPPORT RIGHT SIDE	1	1	1	
59	01-33-495	GASKET-PUMP HOUSING	1	1	1	
60	01-32-251	GASKET-TANK LIP BAFFLE	1	1	1	
61	01-33-565	GUARD-SPLASH	1			
62	01-33-971	GUIDE-FLOAT	1	1	1	
63	01-35-976	HARNESS-MAIN	1	1	1	NOT ILLUST. (SEQ. CODE A THRU H)
63A	01-36-341	HARNESS-MAIN	1	1	1	NOT ILLUST. (BEGINS SEQ. CODE J)
64	09-01-052	HEATER-BLOWER ASSEMBLY	1	1	1	00-57-145 SCREWS 2

ITEM NO.	PART NO.	DESCRIPTION	MODELS			REMARKS
			LCP 44000	LSS 44003	LCF 44004	
65	01-34-964	HEATER	1	1	1	00-75-238 WASHERS 2 00-44-428 NUTS 2
66	01-36-171	HINGE-DOOR, LEFT	1	1	1	09-00-894 SCREWS 2
67	01-36-170	HINGE-DOOR, RIGHT	1	1	1	09-00-894 SCREWS 2
68	01-31-323	HOOK-DOOR SPRING	2	2	2	
69	01-33-689	HOSE-FILL	1			
70	01-33-688	HOSE-DRAIN	1			01-30-105 CLAMP 1
71	01-33-800	HOSE-DRAIN		1	1	09-01-287 CLAMP 1
72	01-35-466	HOUSING-MOTOR	1	1	1	
74	01-36-194	IMPELLER-WASH	1	1	1	09-00-567 SCREW 1
75	01-36-040	INSERT-ESCUTCHEON	1	1	1	
76	01-33-148	INSERT-LOWER BASKET	2	2	2	
77	01-33-235	INSERT-CENTER, UPPER BASKET	1	1	1	
78	01-33-234	INSERT-UPPER BASKET	2	2	2	
79	01-35-852	INSULATION-UPPER PANEL	1	1	1	NOT ILLUSTRATED
80	01-34-061	INSULATION-LOWER PANEL	1	1	1	NOT ILLUSTRATED
81	01-31-315	KNOB-LATCH LEVER	1	1	1	09-00-571 SCREWS 2 09-00-073 WASHERS 2
82	01-36-196	LATCH ASSEMBLY-DOOR	1	1	1	09-00-883 SCREWS 3
83	01-35-930	LATCH BI-METAL ASSEMBLY	1	1	1	
84	09-01-425	LEG BOLT-LEVELING		4	4	09-01-448 NUT 4
85	01-35-742	LEVER TRIP-DETERGENT CUP	1	1	1	
86	01-36-047	LENS-INDICATOR LIGHT	4	4	4	
87	01-36-048	LIGHT-INDICATOR	4	4	4	
88	01-34-695	MOTOR-MAIN PUMP	1	1	1	
89	01-35-740	NUT BEARING-DET. CUP WHEEL	1	1	1	
91	00-44-428	NUT-FLOAT GUIDE & HEATER	3	3	3	
92	09-00-290	NUT-TIE ROD	2	2	2	09-00-065 WASHER 2
93	01-32-800	OVERLAY-HANDLE	1	1	1	
94	01-35-858	PANEL STAINLESS STEEL-UPPER AND LOWER KIT	1	1	1	01-32-461 PLUG 2 NOT ILLUSTRATED
96	01-34-974	PANEL LEFT SIDE-WHITE	1			01-32-547 BRACKET
97	01-34-976	PANEL RIGHT SIDE-WHITE	1			01-32-546 BRACKET
96	01-34-975	PANEL LEFT SIDE-WHITE			1	01-32-547 BRACKET
97	01-34-977	PANEL RIGHT SIDE-WHITE			1	01-32-546 BRACKET
100	01-34-972	PANEL REAR-WHITE (NOT SHOWN)	1			09-00-924 SCREWS 8
101	01-31-310	PIN-DOOR SPRING	2	2	2	
102	01-35-736	PLATE-LATCH BI-METAL ASSEMBLY	1	1	1	
103	01-32-462	PLATE-LATCH & SWITCH	1	1	1	
104	01-32-423	PLATE-STRIKE	1	1	1	
105	01-35-323	PLATE-DOOR STRIKE & TANK RAIL	5	5	5	
106	01-32-360	PLATE ASSEMBLY-TOE	1			09-00-832 SCREWS 4 09-01-269 SCREWS 2
107	01-32-346	PLATE ASSEMBLY-TOE		1	1	09-00-832 SCREWS 4 09-01-269 SCREWS 2
108	01-33-891	PLUG & SCREW KIT-UPPER ARM	1	1	1	01-33-843 PLUG 01-33-842 SCREW
109	01-35-839	PLUG & SEAL-R.I. DISPENSER HOLE	1	1	1	
110	01-36-258	PUMP-DISTILLED WATER	1	1	1	00-57-141 SCREWS 3
112	01-30-845	RAIL-UPPER BASKET, LEFT	1	1	1	
	01-30-844	RAIL-UPPER BASKET, RIGHT	1	1	1	
114	01-36-197	RELAY-DELAY START	2	2	2	01-35-972 BRACKET 1 09-01-386 NUTS 2
114A	01-36-271	RELAY-POWER (SEO.J)	1	1	1	09-01-518 SCREW 2(CHANNEL MOUNTED)
115	01-35-946	RELAY-START	1	1	1	
116	01-31-125	RETAINER-DOOR SEAL, TOP	1	1	1	
117	01-32-087	RETAINER-DOOR SEAL, LEFT SIDE	1	1	1	
	01-32-088	RETAINER-DOOR SEAL, RIGHT SIDE	1	1	1	
119	01-32-553	RETAINER-HOSE	1			09-00-587 SCREWS 2
120	01-30-126	RING "O" WASH IMPELLER	1	1	1	
121	09-00-562	RIVETS-RETAINER TO TANK	19	19	19	NOT ILLUSTRATED
122	01-32-394	ROD-TIE, INNER DOOR	2	2	2	09-00-895 SCREWS 2
123	01-34-304	ROLLER ASSEMBLY-LOWER BASKET	8	8	8	
124	01-30-841	ROLLER-UPPER BASKET RAIL	8	8	8	01-30-839 STUDS 8 00-75-258 WASHERS 8
125	01-34-305	ROLLER ASSEMBLY-UPPER BASKET	4	4	4	
126	09-01-537	SCREW-WASH IMPELLER TO SHAFT	1	1	1	

ITEM NO.	PART NO.	DESCRIPTION	MODELS			REMARKS
			LCP 44000	LSS 44003	LCF 44004	
127	09-01-331	SCREW-DOOR STRIKE TO PLATE	2	2	2	
128	09-01-466	SCREW-HOUSING/DET. CUP ASSY.	1	1	1	
129	09-01-068	SCREW-PUMP HOUSING TO MOTOR	4	4	4	
130	01-31-184	SEAL-DOOR	1	1	1	
131	01-35-899	SEAL-WIRE PROTECTOR	1	1	1	
132	01-34-386	SEAL ASSEMBLY-MOTOR	1	1	1	
133	01-36-249	SEAL-BEARING, LOWER ARM UPPER	2	2	2	TOP AND BOTTOM OF ARM
134	00-64-431	SEAL-BEARING, UPPER ARM	1	1	1	
135	01-33-206	SEPARATOR AND GRID	1	1	1	
136	01-36-332	SKIRT-TOE PLATE		1	1	
137	01-33-616	SLINGER-WATER	1	1	1	
138	09-00-900	SOCKET-CASTERS	4			
138A	00-94-338	SOLENOID- FILL VALVE, DIST.PUMP	1	1	1	
139	01-35-741	SPACER-BEARING/WHEEL	1	1	1	
140	01-32-567	SPACER-SIDE PANEL	2			
141	01-31-324	SPRING-DOOR, WITH HOOK	2	2	2	
142	01-35-739	SPRING-DRIVE, DET. CUP	1	1	1	
142A	01-30-918	SPRING-ARMATURE F.V. DIST. PUMP	1	1	1	
143	01-32-534-01	STRIKE-DOOR LATCH	1	1	1	
144	01-36-302	SWITCH ASSEMBLY-DOOR (SEQ. J)	1	1	1	09-01-474 SCREW
145	01-34-543	SWITCH-FLOAT	1	1	1	
146	01-36-011	SWITCH-PUSH BUTTON ASSEMBLY	1	1	1	09-01-380 SCREWS 2
147	01-36-052	SWITCH-TOGGLE W/HEX NUT	2	2	2	SEQ. A THRU J
148	01-36-138	SWITCH-TOGGLE W/HEX NUT	2	2	2	SEQ. K AND ON
149	01-36-986	TANK AND FRAME ASSEMBLY	1	1	1	
150	09-01-292	THERMOSTAT-BLOWER ASSEMBLY	1	1	1	09-00-792 SCREWS 2
151	09-01-395	THERMOSTAT-160°	1	1	1	
151A	09-01-374	THERMOSTAT-140°	1	1	1	
152	01-35-893	THERMOSTAT-LIMITING	2	2	2	
153	01-36-714	TIMER	1	1	1	09-01-260 SCREWS 2
154	01-32-711	TOP	1			09-00-831 SCREWS 4
	01-32-928	TOP			1	09-00-831 SCREWS 4
157	01-32-701	TRIM STRIP-TOP	1			09-00-905 SCREWS 2
158	01-32-581	TRIM-CASTER FRAME	1			09-00-905 SCREWS 4
159	01-34-878	TUBE-FILL, DOMESTIC WATER	1	1	1	09-00-223 CLIP 1
160	01-32-708	TUBE-FILL, DISTILLED WATER	1	1	1	
161	01-30-915	TUBES-VALVES TO PUMPS	2	2	2	
162	01-32-395	TUBE-DRAIN, COPPER		1	1	01-30-144 CLAMP 1
163	01-36-086	TUBE AND HOOD ASSEMBLY	1	1	1	BLOWER-HEATER SYSTEM
164	01-35-550	VALVE-FILL, DISTILLED WATER	1	1	1	09-01-461 NUT 2 09-00-880 SCREWS 2
165	01-33-833	VALVE-FILL, DOMESTIC WATER	1			09-00-880 SCREWS 2
166	01-33-832	VALVE-FILL, DOMESTIC WATER		1	1	09-01-434 SCREWS 2
167	01-33-452	VANE STRAIGHTENING	1	1	1	09-00-851 SCREWS 2 00-75-258 WASHERS 2
168	09-01-054	WASHER-BLOWER SEAL	1	1	1	
169	00-75-258	WASHER-HINGE TO DOOR & HEATER	2	2	2	
170	01-34-143	WASHER-FLOAT GUIDE	1	1	1	
171	01-35-743	WHEEL ASSEMBLY DET. CUP	1	1	1	09-01-466 SCREW 1
172	09-00-065	WASHER - TIE ROD	2	2	2	

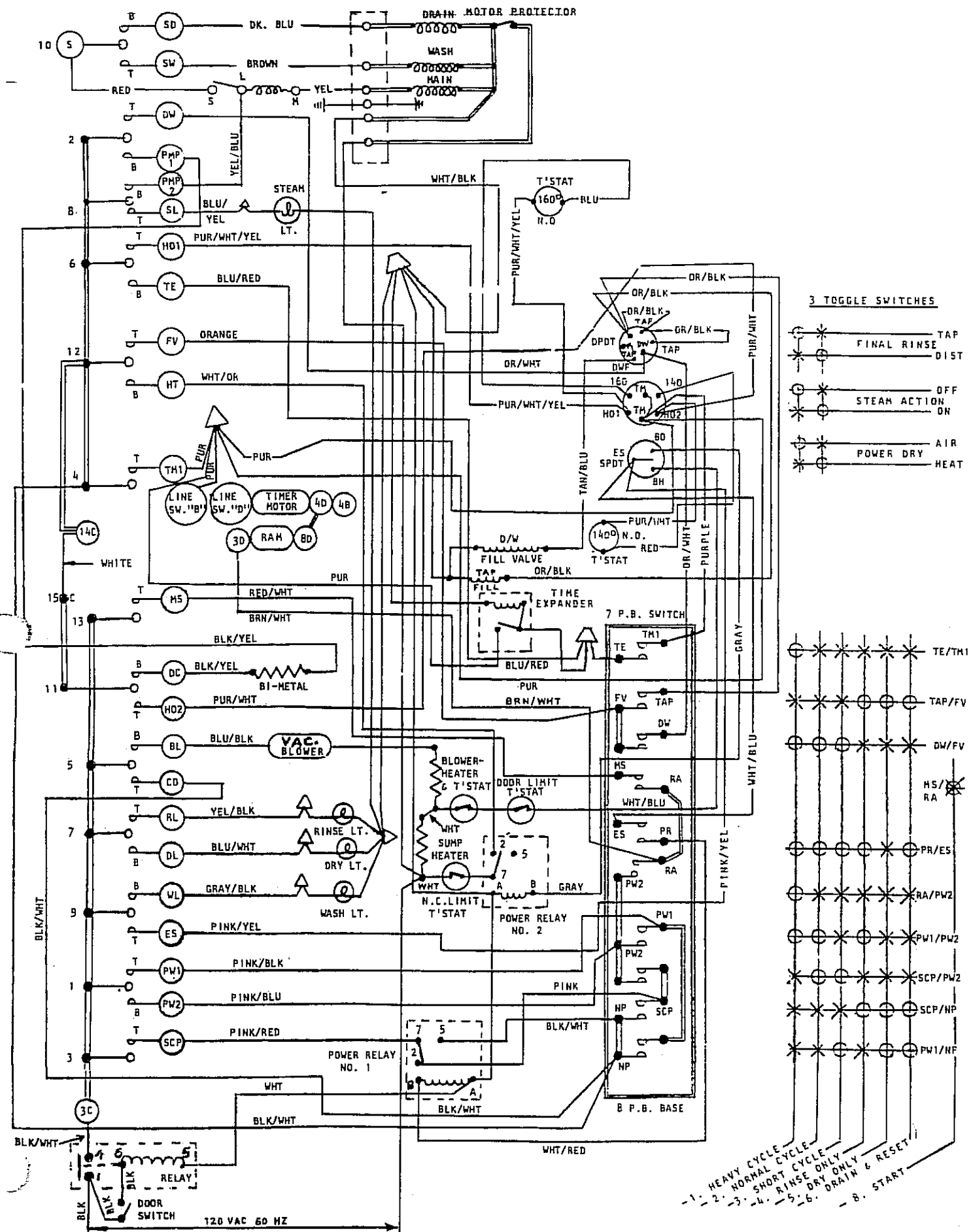

FLASKSCRUBBER TIMER-SEL. SWITCH DIAGRAM